

How do I make Online Purchases at Walmart Using my Hawaii Kokua EBT Card?

1. Update your payment info

- Sign into your Walmart pickup & delivery account. If you don't have one create an account.
- Select **Payment Methods**.
- If your local store accepts EBT Online, you'll see an option to add your EBT card to your account.
- Add your card information, then click **Save Card**.

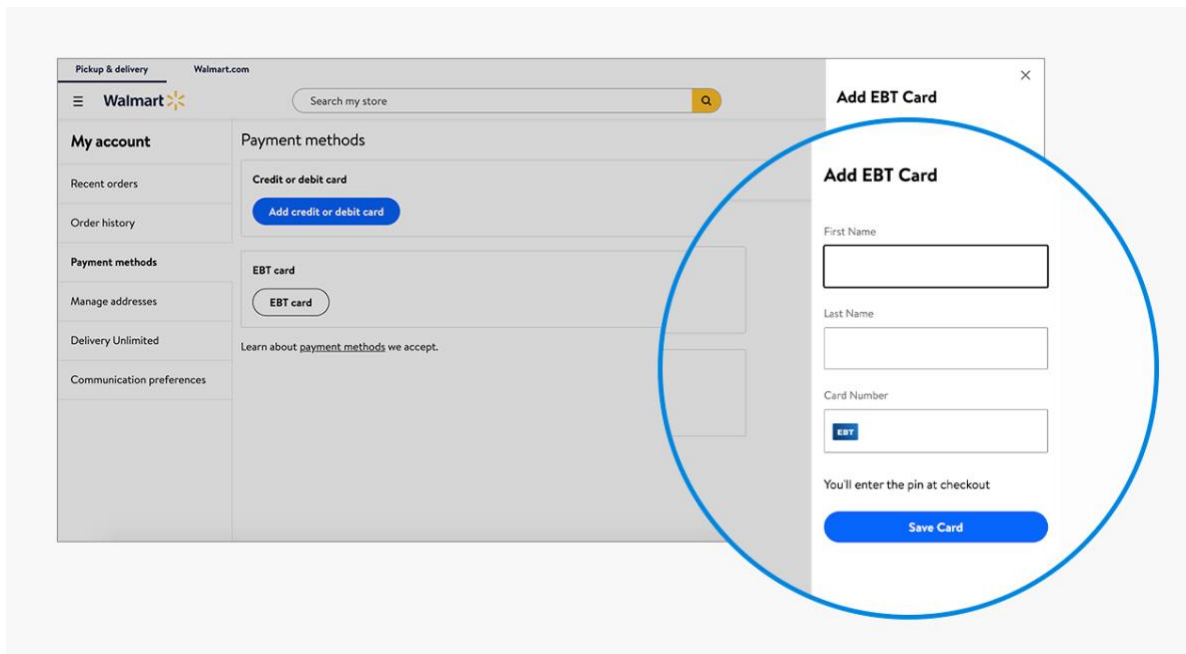

*By connecting your EBT card to your account, you'll be able to use EBT Online with no-basket minimums. (Please allow up to 24 hours for the no-basket minimum to take effect on your account.)

2. Build your cart & check out

- Once your payment information is updated, start adding items to your cart.
- Upon viewing your cart, you'll see the total for EBT-eligible items
- After reviewing, select **Checkout** to proceed.
- At Checkout you can select your delivery options such as grocery pickup or Standard or Express Delivery. To find out if pickup and delivery is availability in your area please go to <https://www.walmart.com/grocery/help>

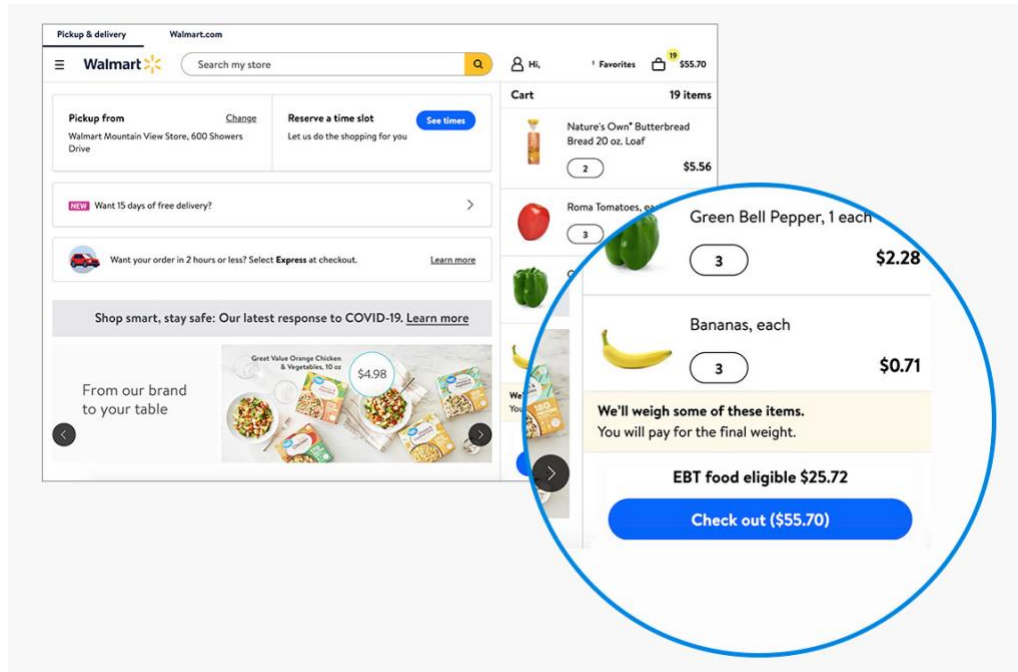

3. Pay with your EBT card

- On the **Select payment method** screen, select the checkbox to pay with EBT.
- Enter the EBT food or EBT cash amount you'd like to use.
- If your EBT funds can't cover the entire order, you can divvy up the remaining amount with a personal debit or credit card.
- Once you're finished entering a payment method(s), select **Continue**.

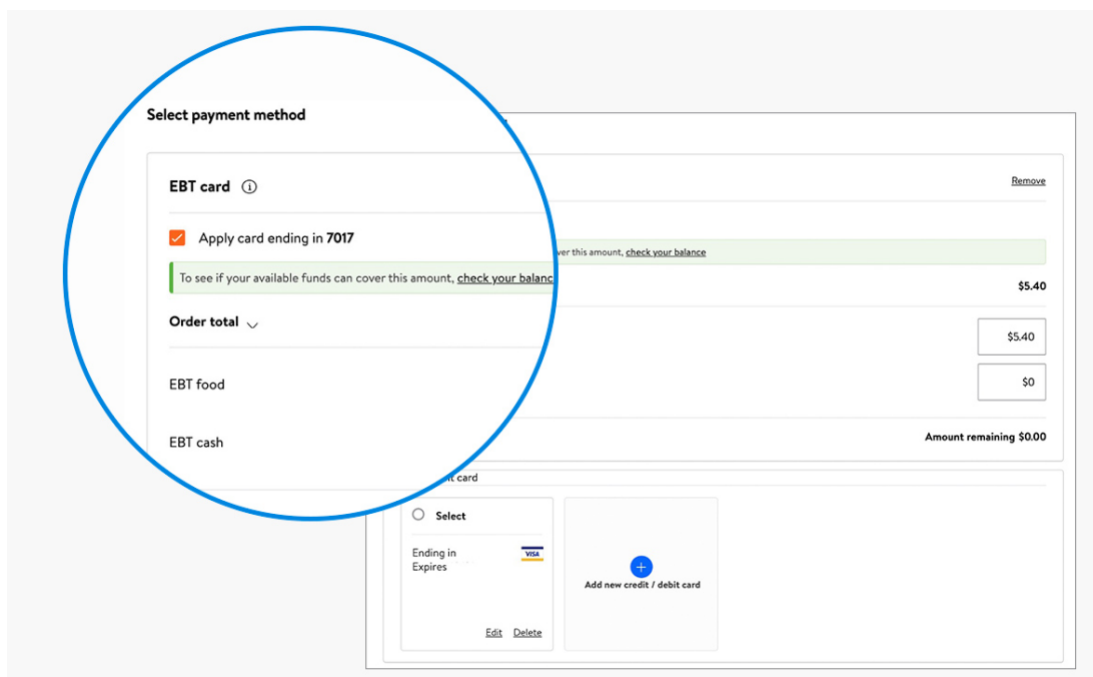

4. Place your order

- After selecting **Continue**, you will be directed to an external page to enter your PIN.
- Please note that the numbers on the pin pad will shuffle after each entry for security purposes.
- Once you've entered your PIN, you'll be linked back to Walmart to Complete your Order.

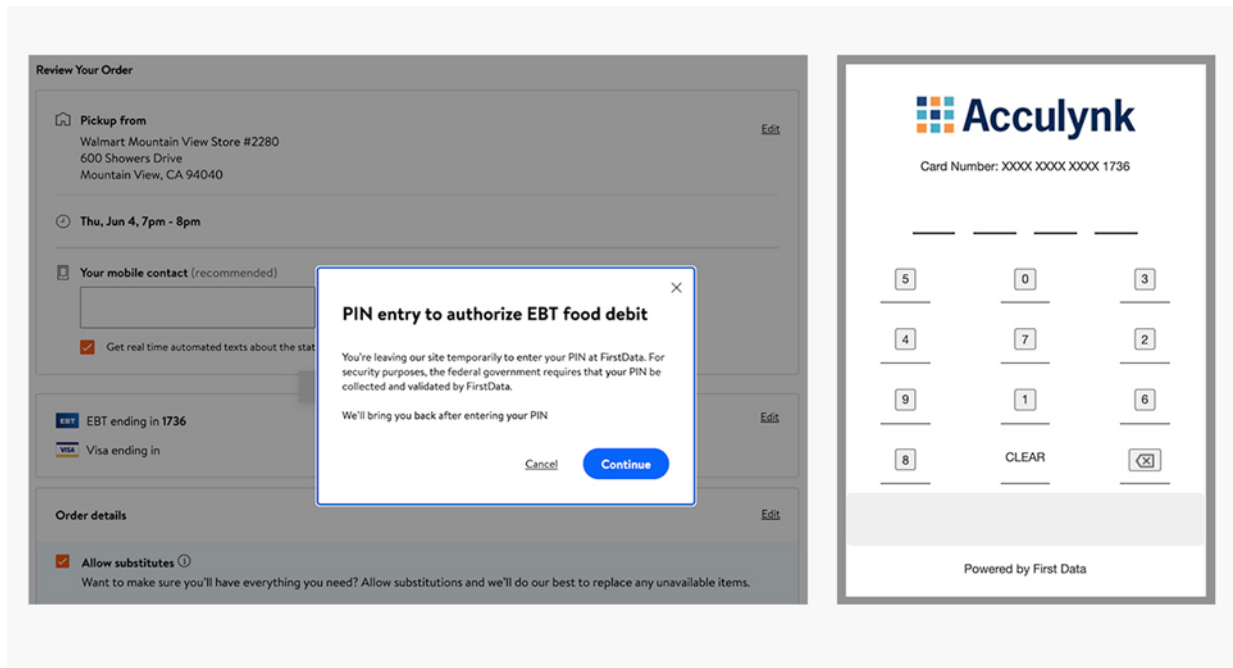

- Once your order completed you will receive a confirmation email regarding your order. If you have selected grocery pickup be sure to follow the pick-up instructions included in your order confirmation.



* Delivery fees may apply; SNAP benefits cannot be used to cover the cost of delivery. Hawaii Walmart online SNAP orders can only accept grocery pickup and express delivery at this time.