

JOSH GREEN, M.D.
GOVERNOR
KE KIA'ĀINA

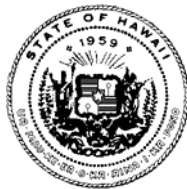

CATHY BETTS
DIRECTOR
KA LUNA HO'OKELE

JOSEPH CAMPOS II
DEPUTY DIRECTOR
KA HOPE LUNA HO'OKELE

STATE OF HAWAII
KA MOKU'ĀINA O HAWAI'I
DEPARTMENT OF HUMAN SERVICES
KA 'OIHANA MĀLAMA LAWELawe KANAKA
Office of the Director
P. O. Box 339
Honolulu, Hawaii 96809-0339

DR 22.050

December 28, 2022

The Honorable Ronald D. Kouchi, President
and Members of the Senate
Thirty-Second State Legislature
State Capitol, Room 409
Honolulu, Hawaii 96813

The Honorable Scott K. Saiki, Speaker
and Members of the House of
Representatives
Thirty-Second State Legislature
State Capitol, Room 431
Honolulu, Hawaii 96813

Dear President Kouchi, Speaker Saiki, and Members of the Legislature:

Enclosed is the report submitted in accordance with Act 125, Session Laws of Hawaii 2022, Relating to Children and Family of Incarcerated Individuals.

In accordance with section 93-16, Hawaii Revised Statutes, the report is available to review electronically at the Department's website, at <https://humanservices.hawaii.gov/reports/legislative-reports/>.

Sincerely,

Cathy Betts
Director

Enclosure

- c: Governor's Office
Lieutenant Governor's Office
Department of Budget & Finance
Legislative Auditor
Legislative Reference Bureau Library (1 hard copy)
Hawaii State Public Library, System State Publications Distribution Center (2 hard copies, 1 electronic copy)
Hamilton Library, Serials Department, University of Hawaii (1 hard copy)

**REPORT TO THE THIRTY-SECOND HAWAII STATE
LEGISLATURE 2023**

**IN ACCORDANCE WITH ACT 125, SESSION LAWS OF HAWAII
2022, RELATING TO CHILDREN AND FAMILY OF INCARCERATED
INDIVIDUALS**

**DEPARTMENT OF HUMAN SERVICES
DIRECTOR'S OFFICE
DECEMBER 2022**

Overview

Governor David Y. Ige signed Act 125, Session Laws of Hawaii 2022 (Act 125), into law on June 27, 2022. In Act 125, amongst other things, the Legislature found "that the prison environment can be frightening and traumatizing for children, both in the attitudes and behaviors of prison staff and the harshness of visitation sites." In addition, it found that establishing "family visitation and resource centers is in the best interest and well-being of children and, as studies suggest, may have many benefits for the incarcerated parent and other family members, the community, and the State."

Act 125 requires the Department of Human Services (DHS) and Department of Public Safety (PSD), family reunification working group, and other entities serving children and families affected by parental incarceration to establish a pilot visitation and family resource center at Waiawa Correctional Facility on Oahu. DHS convenes the working group.

Act 125 requires the working group to submit its findings and recommendations, proposed legislation, and estimated costs to run a sustainable pilot visitation and family resource center at Waiawa Correctional Facility required by Act 125.

Introduction

Blueprint for Change is a non-profit organization contracted by DHS Child Welfare Services to operate Neighborhood Places. There are seven (7) Neighborhood Places across the islands that are safe places to meet the needs of children and families. Neighborhood Places are Family Resource Centers (FRCs) and serve as welcoming hubs of community services and opportunities designed to support and strengthen families. FRC activities and programs are trauma-informed and incorporate the 5 Protective Factors. Programs are usually provided at no or low cost to participants and aim to reflect and respond to communities' specific needs, cultures, and interests. The FRCs are inclusive and diverse and provide programs and information in the native languages of those populations in the community.

FRCs play a critical role in preventing child abuse and neglect; strengthening children and families; connecting family—impacting agencies and programs; creating opportunities for community-level coordination; creating connections to resources and support systems; and increasing family engagement, which all lead to greater student success in school.

Blueprint for Change saw that many of the children they served had incarcerated parents. As a result, these children faced additional challenges and stressors.

Background

In January 2014, the Legislature's Keiki caucus established the family reunification working group to explore issues surrounding children and families impacted by incarceration. The group established two priorities: a database of children in Hawaii impacted by incarceration and a one-stop resource center for these children and their families. Act 16, Session Laws of Hawaii 2015, required PSD to collect data at the point of intake on the number of minor children from

each incarcerated parent. PSD identified approximately four thousand children with an incarcerated parent at that time.

In 2016, the Waikiki Health Center started the Pu'uuhonua Prison Program to give former inmates a fresh start to better, healthier lives. In 2019, House Concurrent Resolution (HCR) 205 requested the working group to develop a plan to establish children-friendly and family-friendly visitation centers at all state correctional facilities to ensure the well-being of children of incarcerated parents and their families. The group proposed the establishment of a pilot visitation and family resource center project at the Waiawa Correctional Facility on Oahu.

Activities

- The Working group met in July 2022 to celebrate the passage of Act 125 and Act 129 Relating to Family Resource Centers. DHS explained the interconnection between the two Acts and sought pathways for further collaboration. See attached Act 125 & Act 129 Family Resource Centers.
- DHS is requesting the release of appropriate funds from the Department of Budget & Finance to the Benefit, Employment & Support Services Division (BESSD) Temporary Assistance to Needy Families (TANF) fund.
- PSD is requesting the release of appropriated funds for Waiawa Correctional Facility and approval for draft plans and other building materials for the FRC. The final design is not complete; only renovations to the existing building are planned.
- The working group met in November 2022. Participants provided updates, Waiawa Correctional Facility readiness status, and the next steps discussed. See attached Act 125 Meeting Minutes November 22, 2022.
 - Discussion included national changes in using "child visitation" and adverse connotations of the meaning;
 - The workgroup discussed a recommendation to reframe the action as "child visiting," and a suggested name is the Waiawa Child and Family Visiting Center.
- Blueprint for Change presented a training session at the Hawaii Children's Trust Fund in November 2022;
- Reported on Waiawa Correctional Facility building readiness;
- Re-distributed prior work on a modular diagram of the Center. Currently, no outdoor play area space is in the building plan;
- Shared article on [Visiting Mom and Dad – The Child's Perspective](#) from Children of Incarcerated Parents Library;
- Shared YouTube video on "[Exploring FRCs in Unique Settings \(Prison-based FRC\)](#) https://www.youtube.com/watch?v=vwgzJ_jJKg."
- BESSD posted a Request for Information (RFI) on home visiting programs and services to address adverse childhood experiences (ACEs) of parents with young children, which specifically included services provided to families with incarcerated parent(s) at public correctional facilities.
- Drafted proposed legislation for improvements required by the Waiawa Correctional Facility, including an ADA restroom with a diaper changing station (including water and sewage), IT infrastructure, modular structures, and air conditioning.

- Presentations on FRCs include Waiawa Correctional Facility as a future FRC site.

Findings and Recommendations

- Conduct a virtual site visit(s) of other Family Resource Centers/Child Visiting Centers at correctional facilities:
- Review earlier intervention strategies that increased parent-child interactions from the HCR 205 2019 Report.
- Consider a Call to Action to explore opportunities for the community to help beautify the area around the building site.
- Discuss ways to help the caregiving parent deal with the emotional aspect of visiting an incarcerated individual, pre-visit preparations, debriefing, and referrals for emotional support or other services after the visit when the family is home.
- Discuss better ways to prepare for the visit logistics. The caregiving parent must manage the long wait times before the actual visit. Sometimes, the wait times range from two to five hours. Depending on the age of the infant or child, drinks and snacks are needed, a place to store baby bottles or medication that needs refrigeration, and to heat milk for babies, if needed.
- Discuss waiting areas for children and families before the actual visit. See Mockup WCF Visiting Center Design.

Proposed legislation

The workgroup discussed a legislative proposal to request additional time to expend the appropriated funds and to request additional funds. Members decided to propose legislation in the first year of the biennium instead of waiting for the second year. The bill will include an additional two years of funding for the completion of air conditioning, an ADA-compliant restroom with a diaper changing station, modular structures, and IT infrastructure for Internet/Wi-Fi 5G access. See attached Waiawa Bill Proposal.

Estimated costs

Act 125 provided initial year funding for the Center and funds to renovate Waiawa Correctional Facility. Upon further review and discussion, PSD informed the workgroup that the Center should include an ADA-compliant restroom with a diaper changing station, modular structures, air conditioning, and IT infrastructure for Internet/Wi-Fi access. These additional considerations were not included in the initial request for appropriations.

Estimated additional expenditures for the Center are:

- The cost to operate, furnish, and maintain the Center is \$350,000, including funds to contract 3-4 full-time positions;
- IT infrastructure for Internet/WIFI 5G access will require \$10,000;
- An internet search of the estimated cost of an ADA-compliant bathroom had estimates that started at \$15,000 - \$30,000.



CELEBRATE: ACT 125 & ACT 129 (2022) VISITATION CENTER & FAMILY RESOURCE CENTERS

Supporting Children & Families
July 22, 2022



AGENDA

- WELCOME
- CELEBRATION & REFLECTION JAMBOARD:
https://jamboard.google.com/d/13rP9Qyk36Eu0OHY86_9BFAB7yD3riwTxFOotDz6NikM/edit?usp=sharing
- QUICK INTROS
- HOW WE GOT HERE (AGAIN?)
- SUMMARY ACT 125 & ACT 129
- BACKGROUND FAMILY RESOURCE CENTERS
- NEXT STEPS
- MEETING CADENCE & GOOGLE DRIVE

How we got here (again?)



Visitation Center at Waiawa and Family Resource Center Network

1994

SCR 89 HD1

*Blueprint For
Change
Workgroup*

1996

Act 302

*Child Protective
Services Reform
Coordinating
Committee –
develop 2
Neighborhood
Places*

2008

Act 7

*§346-14.3, HRS
Guiding Principles:
Children of
Incarcerated
Parents*

2018-
2020
*Pandemic
Session*

Act 16 (2015) requires PSD to count minor children of inmates

Keiki Caucus

- 2018 HB2160/SB2305
- 2019 HCR 205/SCR 7
– work group
- 2020 HB2111/SB2345
visitation center @
Waiawa pilot

2022

Act 125 & Act
129

*Visitation Center,
Family Resource
Center at Waiawa
CCC & Family
Resource Center
Network Pilot*

ACT 125/HB1741— RE: CHILDREN & FAMILY OF INCARCERATED INDIVIDUALS



POPULATION: CHILDREN &
FAMILY OF INCARCERATED
PARENTS



PARTNERS: COMMUNITY
ADVOCATES, HUMAN SERVICES,
PUBLIC SAFETY, LEGISLATURE



GOAL: FAMILY VISITATION
CENTER AT WAIAWA & FAMILY
RESOURCE CENTER

ACT 125 - COMPONENTS

- Lead agency – DHS, Director's Office
- DHS to work with PSD, family reunification working group, and other entities serving children and families affected by parental incarceration
- Establish a pilot visitation and family resource center at Waiawa Correctional Facility
- Trauma-informed services
- Workgroup: report recommendations, propose legislation, & additional costs; workgroup ceases January 31, 2023
- Appropriations:
 - \$305,000 to DHS to establish a pilot visitation & resource center at Waiawa (i.e., contract services)
 - \$115,000 to PSD to establish a pilot visitation and resource center (i.e., space renovation, modification)

ACT 129/SB3111— RE: FAMILY RESOURCE CENTERS



POPULATION: CHILDREN &
FAMILY



PARTNERS: COMMUNITY &
SCHOOL-BASED COMMUNITY
RESOURCE CENTERS, ADVOCATES,
HUMAN SERVICES, EDUCATION,
HEALTH



GOAL: ESTABLISH STANDARDS
FOR FAMILY RESOURCE
CENTERS & NETWORK

ACT 129 - COMPONENTS

- Lead agency – DHS, Director's Office
- Further develop and implement a statewide network of school- and community-based family resource centers
- Establish definitions, standards, and best practices
- Develop referral and data tracking protocols
- Identifies minimum requirements and definitions
- DHS, DOH, DOE:
 - authorized to coordinate with other public or private entities
 - Authorized to accept private or public funds
- By December 1, 2023: need to establish criteria, metrics, control, describe data and referral system needs and protocols
- Appropriations:
 - 1 FTE family resource coordinator
 - \$300,000 appropriation to DHS

FAMILY RESOURCE CENTER HISTORY

- Establishment of settlement houses in major metropolitan areas in the late 1800s to support the large number of immigrants entering the country
- Provided support, job training, English classes, and social advocacy as a means to assist them in understanding, adapting to, and succeeding in American society



Good Samaritan Settlement House



Good Samaritan
Family Resource Center

HAWAII 'OHANA SUPPORT NETWORK (HOSN)

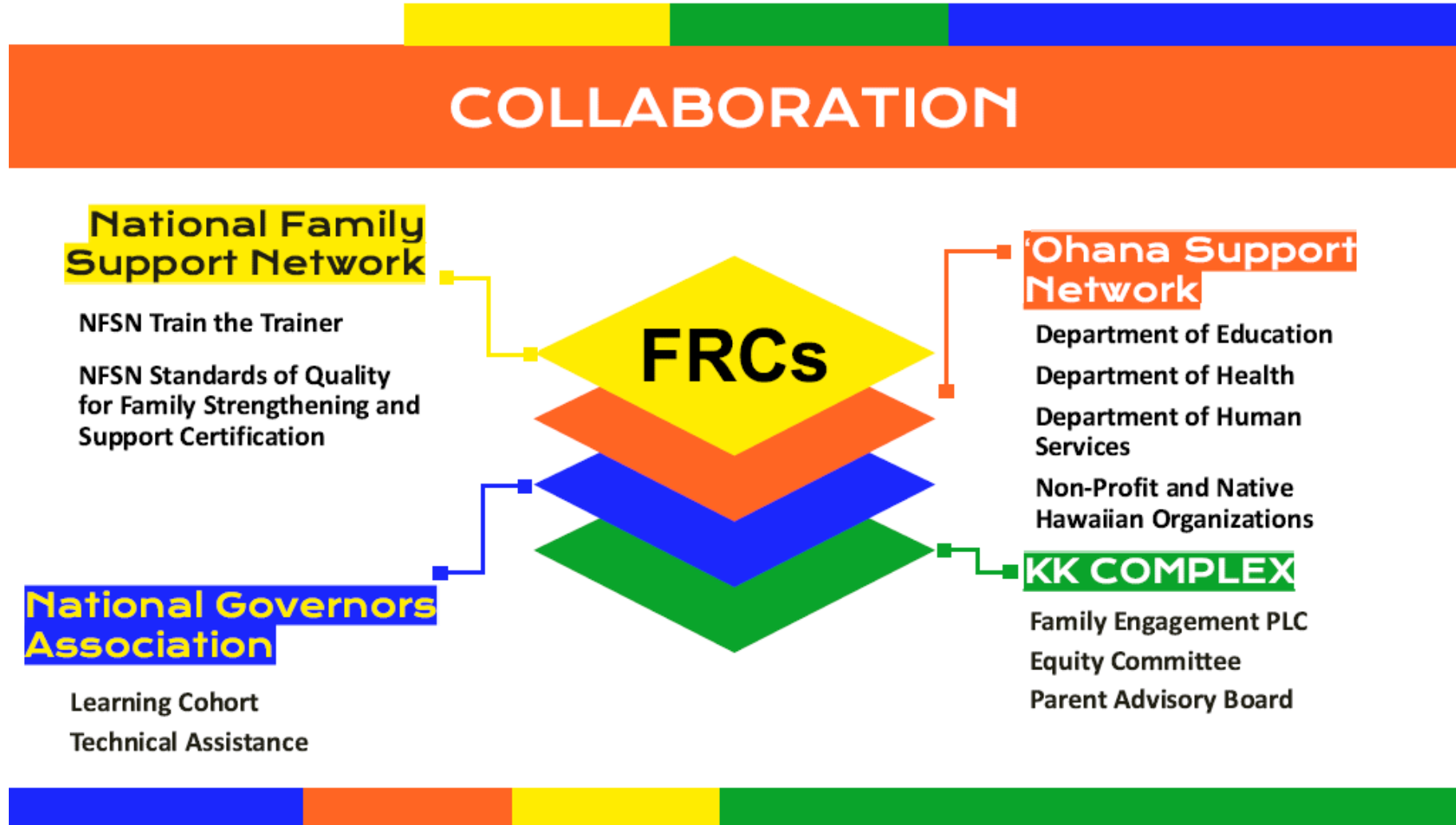

FAMILY RESOURCE CENTERS

- Multi-generational, strengths-based, family-centered approach
- Designed for all families
- No or low cost for participants
- Support families to build protective factors

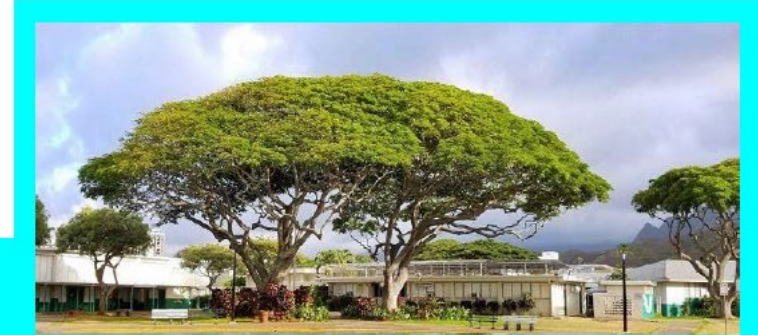

Revised with Hawaii photos

STRENGTHENING FAMILIES PROTECTIVE FACTORS

Parental Resilience

Social Connections

Concrete Support
in Times of Need

Knowledge of Parenting and Child
Development

Social and Emotional Competence
of Children



**Waimanalo Elementary
& Intermediate School**



Revised with Hawaii photos.

*For more information, please see
www.cssp.org/reform/strengthening-families*



NATIONAL
Family Support
NETWORK

FAMILY RESOURCE CENTERS

- No dedicated federal funding
- More than 3,000 nationwide
- Serve more than 2 million people annually



Kailua High School



Revised with Hawaii photos

FAMILY RESOURCE CENTERS



- Cost-effective
- Highly adaptable
- Successful outcomes

Family Resource Centers



FAMILY RESOURCE CENTER NETWORKS



NFSN photo swapped with Hawaii photo

- FRCs are of, by, and for the community:
 - Families are engaged in shaping the programs and services to be responsive to their interests and needs
 - Staff hired who represent and shared the lived experiences of the diversity of the families served
 - Parent Advisory Committees impact program development and implementation

DOE: FAMILIES NEEDED HELP ACCESSING RESOURCES DURING THE PANDEMIC



Family Resource Centers

- Most Common Service Areas:

- Parenting Support



- Access to Resources



- Child Development Activities

- Parent Leadership Development

What Happens in the school-based FRCs



COFFEE AND A BITE



Aloha WEIS Parents, Grandparents and/or Guardians!
Drop off your child(ren) at school, then drive by or walk by and grab a free coffee and light snack before you leave.

WHEN: Thursday, February 18th, 2021

TIME: 7.45 am to 8.15 am

WHERE: Front of the school office building

Mahalo for supporting our school...Fuli Soa (WEIS Family Resource Center)



Parent Talk #2: How do I help my child stay motivated to learn?

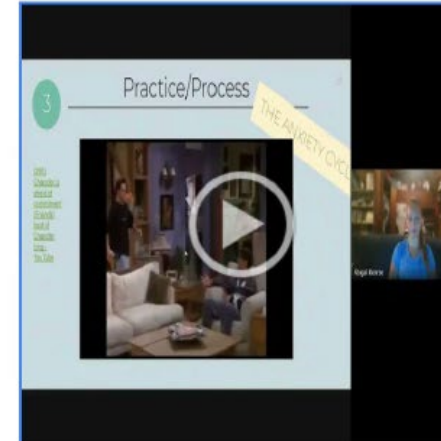

Parent Talk #3: Anxiety, Depression, and Mental Health

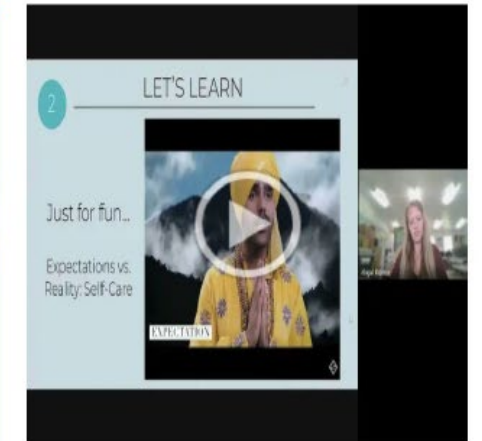

Parent Talk #4: Self-Care for Self and Family Health

EXISTING

Hawaii 'Ohana Support Network – www.Hawaiiohanasupportnetwork.org
statewide collaboration between state and nonprofit organizations to promote and support Family Resource Centers

Established training:

- Standards of Quality for Family Strengthening & Support (2-year certification)
- Parent Advisory Committees
- NFSN Standards Program Assessment to inform immediate and long term goals and to provide ongoing monitoring and evaluation.
- Core Services (parent education, child development activities, resource and referral, drop-in availability, peer-to-peer supports, life skills advocacy)

Family Resource Center Framework

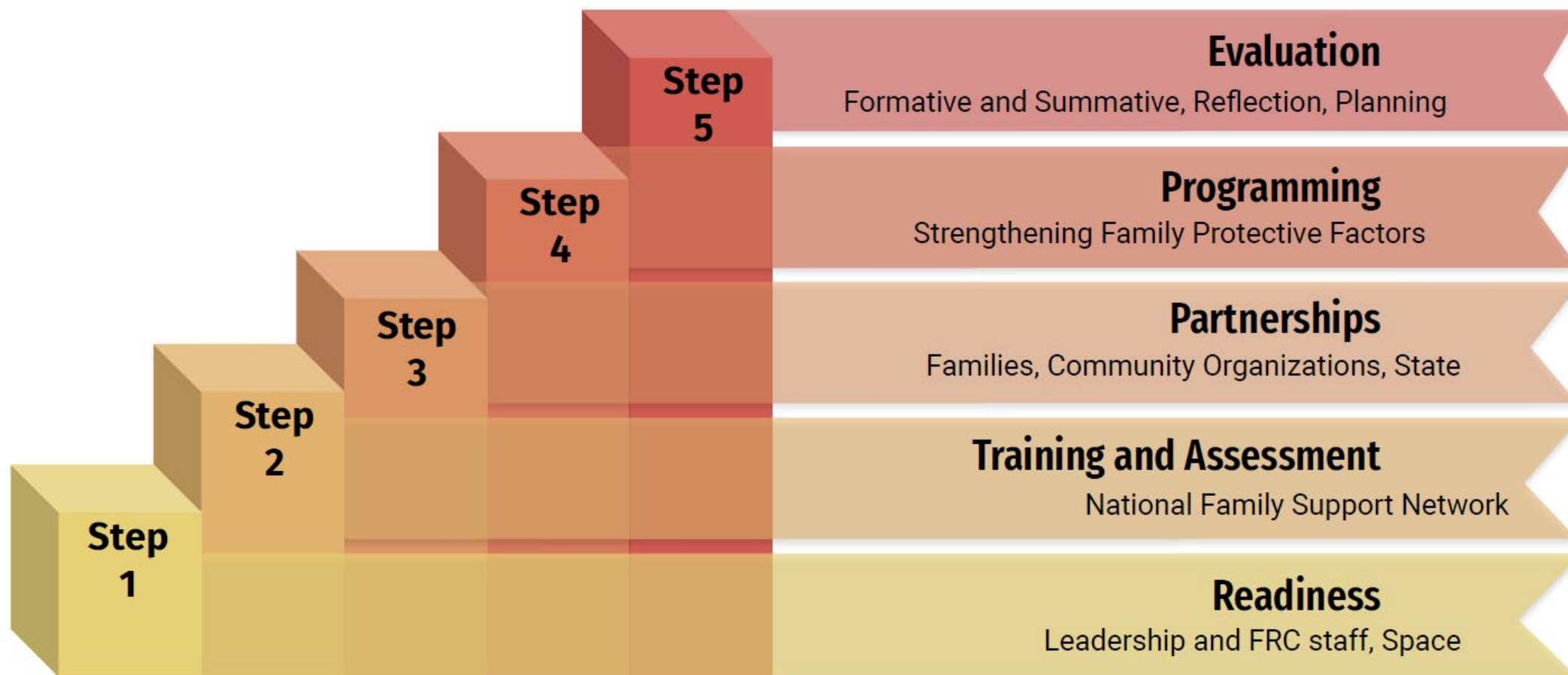

NEXT STEPS:

Short Term

Resource mapping?

What do families want?
What do children need?

What do communities want?

RFI process for services:

- Visitation Center
- Family Resource Centers

Long Term

Advisory committee

Draft standards

Establish networks

Data sharing - agreements

Funding & Infrastructure

MEETING CADENCE & GOOGLE DRIVE

Meetings

Google Drive

POINTS OF CONTACT

Katherine Korenaga, Department of Human Services
Family Resource Center Coordinator

Email: kkorenaga@dhs.Hawaii.gov

Phone: (808) 586-4882

S. Kukunaokala Yoshimoto

Blueprint for Change

Co-Chair, Hawaii 'Ohana Support Network (HOSN)

Email: s.kukunaokala@blueprintforchange.org

Phone: (808) 838-9900

Dr. Kathleen O'Dell

Hawaii 'Ohana Support Network (HOSN) Coordinator

Co-chair, Hawaii 'Ohana Support Network

Email: drkatodell@gmail.com

Phone: (330) 573-8733

Malia Taum-Deenik, Department of Human Services
Director's Office

Email: mtaum-Deenik@dhs.Hawaii.gov

Phone: (808) 586-4978

Shari Kimoto, Public Safety Department

Email: shari.l.kimoto@hawaii.gov

Phone: (808) 587-1277

Kat Brady

Community Alliance on Prisons Hawaii

Email: kat.caphi@gmail.com

Phone: (808) 927-1214

Mahalo!



Act 125 (SLH 2022)

Minutes

Meeting #2: November 22, 2022

Time: 9:30 - 11:00 a.m. (vis MS Teams)

1. Welcome/Introductions

Community

Kat Brady, Community Alliance on Prisons

Stephen Morse

Francine Dudoit, Waikiki Health Center

Kathleen O'Dell, Hawaii 'Ohana Support Network

Marty Oliphant, Liliuokalani Trust

Malia Peters

S. Kukunaokala Yoshimoto (Kukuna), Blueprint for Change

Lilinoe Kauahikaua, Papa Ola Lokahi

Department of Public Safety (PSD)

Shari Kimoto

Scott Swift

Department of Human Services (DHS)

Mimari Hall

Katherine Korenaga

Malia Taum-Deenik

DHS/Benefit, Employment & Support Services (BESSD)

Scott Nakasone

DHS/Social Services Division (SSD)

Daisy Hartsfield

Tim Hitchens

Roseline Tupou

Florence Calderon

2. No minutes from July 22, 2022 meeting – see attached Celebration of Acts 125 and 129 PDF.

3. Updates:

- a. Department of Human Services (DHS) – Katherine informed members that the department is in the process of requesting release of appropriated funds in the amount of \$305,000 to be transferred to BESSD/TANF (Temporary Assistance to Needy Families)
- b. Department of Public Safety (PSD) – Shari reported that they are in the process of requesting release of the appropriated funds for Waiawa and approval of draft plans and materials for the Child Visitation Center. She is working with Warden Monteilh. Scott Swift noted that the final design is not completed, only renovations are planned.
- c. Other – Kukuna referenced national changes in connotation of “child visitation.” The suggested wording is “child visiting.”

4. Status

- a. Waiawa Correctional Facility readiness
- b. Request for Information (RFI) - Family Home Visiting Services to Address Adverse Childhood Experiences (ACEs) No. FFI-903-23-02-S- responses must be received by 11/30/22 at 4:30 p.m. HST. Attached.
- c.

5. Next steps:

- a. Conduct a virtual site visit(s) of other Family Resource Centers/Child Visiting Centers at correctional facilities with a focus on those that are operated by a community-based organization [Friends Outside](#) was a great model for the FRWG to work from.
- b. Review previous proposals from the HCR 205 2019 Report. Kukuna provided resources – modular Child/Family Visiting Center diagram (attached), an article, [Visiting Mom or Dad - The Child's Perspective](#), and YouTube video on [“Exploring FRCs in Unique Settings \(Prison-based FRC\)”](#) https://www.youtube.com/watch?v=vwgzJ_jJKg
- c. Consider a Call to Action (kahea) to explore opportunities for the community to help beautify area around the building site.
Draft legislation for additional funds to build an ADA compliant restroom with a diaper changing station (including water and sewage costs), Internet/WiFi – 5G access, modular furnishings, and air conditioning. There was discussion about whether to submit a legislative bill even though the appropriate funds have not been expended and other requests were not permitted. Caution was advised to the members on getting ahead of ourselves. Members decided to submit legislation at the beginning of the biennium instead of waiting for the second year of the biennium. Malia will draft legislation. However, the bill will be

initiated by the community as both DHS and PSD already submitted their administrative bills.

- d. Discussed ways to help the caregiving parent deal with the emotional aspect of visiting an incarcerated individual, briefing, and debriefing the visit, and moral and emotional support after the visit when the family is at home.
 - e. Discussed better ways to prepare for the visit. The caregiving parent must manage the long wait times before the actual visit. Sometimes, the wait times range from two to five hours. Depending on the age of the infant or child, drinks and snacks are needed, a place to store baby bottles or medication that needs refrigeration, and to heat milk for babies, if needed.
 - f. Discuss waiting areas for children and families before the actual visit.
6. Next meeting: January 2023, 4th week of the month. Katherine will send out the meeting invitation.
7. Meeting Adjourned: 11:00 a.m.

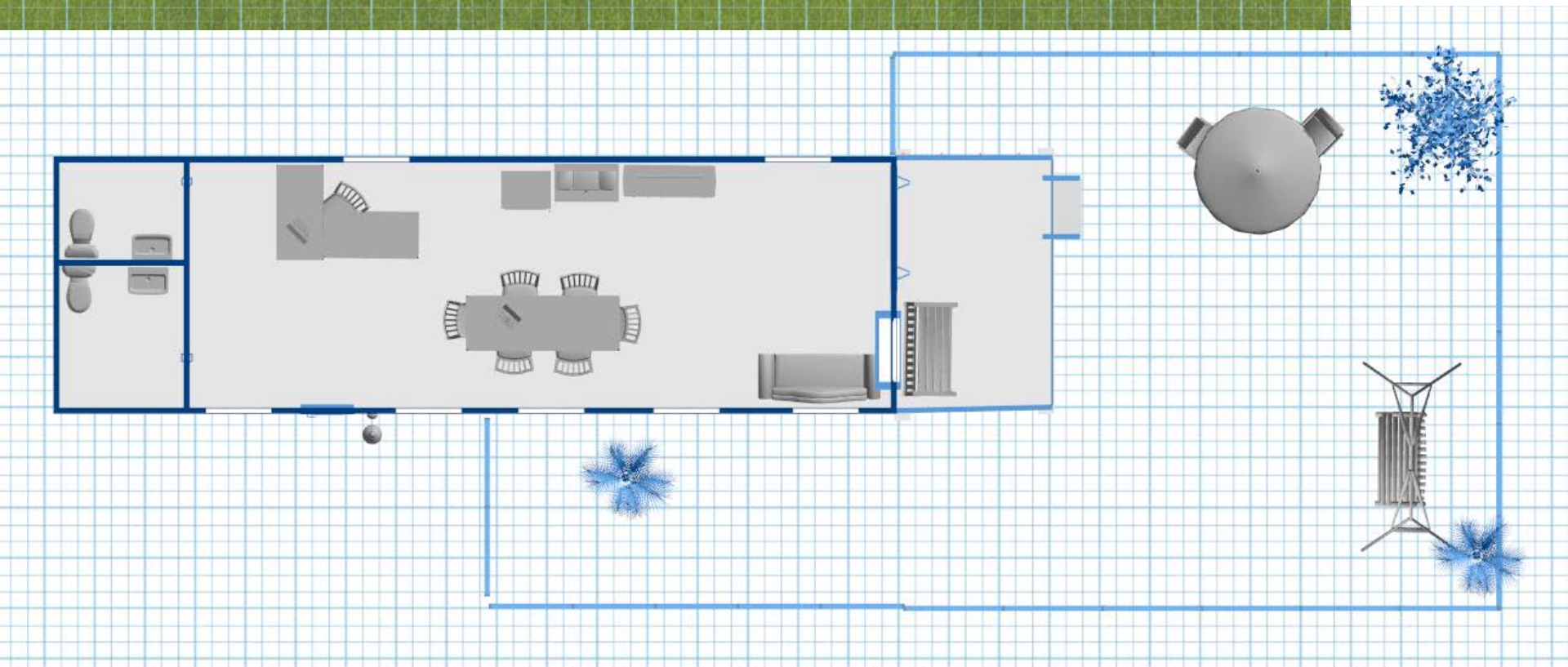



____.B. NO.

A BILL FOR AN ACT

RELATING TO CHILDREN AND FAMILIES OF INCARCERATED INDIVIDUALS.

BE IT ENACTED BY THE LEGISLATURE OF THE STATE OF HAWAII:

1 SECTION 1. The purpose of this Act is to amend Act 125,
2 Session Laws of Hawaii 2022, to extend the time to expend the
3 appropriations and to request additional appropriations for two
4 additional years to implement the pilot visitation and family
5 resource center at the Waiawa Community Correctional Center.

6 SECTION 2. Act 125, Session Laws of Hawaii 2022, is
7 amended by amending sections 3 and 4 as follows:

8 "SECTION 3. There is appropriated out of the general
9 revenues of the State of Hawaii the sum of \$305,000 or so much
10 thereof as may be necessary for fiscal year 2022-2023 for the
11 establishment of a pilot visitation and family resource center
12 at Waiawa correctional facility on Oahu.

13 The sum appropriated shall be expended by the department of
14 human services for the purposes of this Act.

15 The appropriation made by this Act for fiscal year 2022-
16 2023 shall not lapse at the end of the fiscal year for which the
17 appropriation is made; provided that any unexpended and

____.B. NO.

unencumbered balance of the appropriation as of the close of
business on June 30, 2025, shall lapse.

SECTION 4. There is appropriated out of the general revenues of the State of Hawaii the sum of \$115,000 or so much thereof as may be necessary for fiscal year 2022-2023 for the establishment of a pilot visitation and family resource center at Waiawa correctional facility on Oahu.

The sum appropriated shall be expended by the department of public safety for the purposes of this Act.

The appropriation made by this Act for fiscal year 2022-2023 shall not lapse at the end of the fiscal year for which the appropriation is made; provided that any unexpended and unencumbered balance of the appropriation as of the close of business on June 30, 2025, shall lapse."

SECTION 3. There is appropriated out of the general revenues of the State of Hawaii the sum of \$305,000 or so much thereof as may be necessary for fiscal year 2023-2024 and \$305,000 or so much thereof as may be necessary for fiscal year 2024-2025 to operate the pilot visitation and family resource center at Waiawa correctional facility on Oahu.

The sum appropriated shall be expended by the department of human services for the purposes of this Act.

The sum appropriated shall be expended by the department of public safety for the purposes of this Act.

SECTION 6. This Act shall take effect upon its approval, provided that section 2 shall take effect on June 29, 2023.

BY REQUEST